

# Ride Safer<sup>®</sup> 3 Gen 3

## BELT POSITIONING TRAVEL VEST



Model Numbers:  
JD15200xxx  
JK15200xxx



### SIZE - LARGE

For Children:  
50 to 80 lbs. (22.7 to 36.3 kg).

For use **ONLY** with vehicle lap and shoulder belt.

**NOT** for use with vehicle lap belt only.

- Keep this manual for future use.
  - Store in pocket located on right front panel of vest.
- Para instrucciones en Español, llamar al:  
1-847-233-0365 o  
www.safetrafficsystem.com  
o www.ridesafer.net

### Registration Information

Restraint systems could be recalled for safety reasons. You must register this restraint to be reached in a recall. Fill out the registration card attached to vest and mail today, register online at [www.safetrafficsystem.com/rev3/registration.html](http://www.safetrafficsystem.com/rev3/registration.html) or send your name, address, e-mail address if available and the restraint's model number and manufacturing date to:

Safe Traffic System, Inc.  
10201 Pacific Ave., Franklin Park, IL. 60131 USA  
or call 1-847-233-0365 or fax 1-847-233-0384

### For recall information:

- Call Safe Traffic System, Inc. at 1-847-233-0365
- Log onto [www.safetrafficsystem.com](http://www.safetrafficsystem.com) or [www.ridesafer.net](http://www.ridesafer.net)

### Distributed By:

Safe Traffic System, Inc.  
10201 Pacific Ave., Franklin Park, IL. 60131 USA

©2013 Safe Traffic System, Inc.  
U.S. Pat. 6,902,193 B2  
Made in Vietnam

10-154-01-01B 0913

## ⚠ WARNING ⚠

### DEATH or SERIOUS INJURY can occur

- Failure to follow these instructions and vest labels can result in child striking the vehicle's interior during a sudden stop or crash.
- Use only with children who weigh between 50 and 80 pounds (22.7 and 36.3 kg) and whose height is between 45 and 57 inches (114 and 145 cm).
- Snugly adjust vest and vehicle seat belts around child. See seat belt adjustment instructions in vehicle owner's manual.
- Always position and snugly adjust lap belt, then adjust shoulder belt.
  - Lap belt must be low on hips, contacting thighs, not on abdomen.
- **NEVER USE VEHICLE LAP BELT ONLY.**
- Shoulder belt must always be positioned on child's shoulder. NOT under arm or behind back.
- Do not use with the vehicle lower anchorages of the child restraint anchorage system or LATCH system.
- Follow all instructions in this manual and on the child restraint.
- Register your child restraint with the manufacturer.
- **DO NOT** allow any use of vest after a crash unless crash and vest meets all conditions in "Re-use After A Crash" section.

## SAFETY CHECK LIST

- ✓ Read and understand instruction manual and vest labels.
- ✓ Position and snugly adjust lap belt, then shoulder belt.
- ✓ Harness belts are adjusted so lower panels contact top of thighs and top of vest rests on child's shoulders.
- ✓ Lap belt must be low on hips, contacting thighs, not on abdomen.
- ✓ **NEVER USE VEHICLE LAP BELT ONLY.**
- ✓ Secure child in back seat whenever possible.
- ✓ Top of child's ears must be below top of vehicle seat back.
- ✓ Never leave child unattended.
- ✓ Discontinue use when child's weight exceeds 80 pounds (36.3 kg).
- ✓ Do not allow anyone (babysitter, relatives, etc.) to use travel vest without first understanding all instructions.
- ✓ Secure or store this vest when not occupied. An unsecured child restraint system can injure other occupants in a crash.
- ✓ Discontinue use after 10 years from the "Manufactured In" date printed on inside of vest.

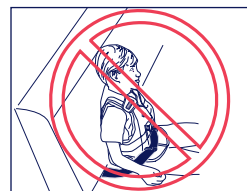

## HEIGHT & WEIGHT INFORMATION

- Requirements for use:
  - Weight between 50 and 80 lbs. (22.7 and 36.3 kg).
  - Height between 45 and 57 inches (114 and 145 cm).
  - Must be used with vehicle lap and shoulder belt. Never use with lap belt only.
- Fit of vest on child:
  - Vest **MUST** adjust to fit snugly around child's chest.
  - Length - vest must contact top of child's thighs and top of shoulders when sitting.
  - Must be used with vehicle lap and shoulder belt. Never use with lap belt only.
- Discontinue use when:
  - Vest is too small to fit around child's chest.
  - Bottom of front panels do not contact top of child's thighs when seated.
  - Child's weight exceeds 80 pounds (36.3 kg)



Use with vehicle lap and shoulder belt.

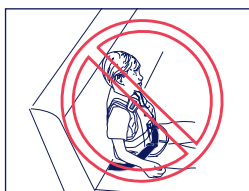

Lap belt ONLY.

3

## RIDESAFER TRAVEL VEST & PARTS

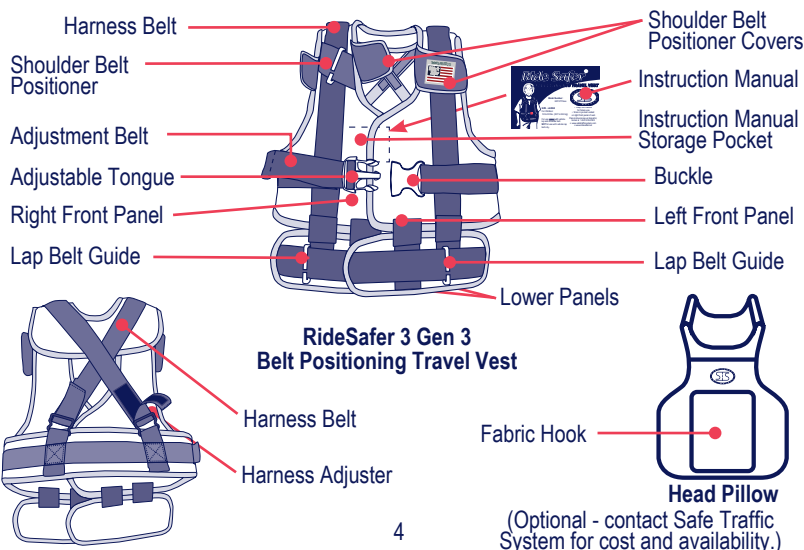

4

## SELECTING A VEHICLE SEATING LOCATION

The RideSafer 3 Belt Positioning Travel Vest is designed for use **ONLY** with a vehicle lap belt and shoulder belt. Never use with lap belt only

- Refer to vehicle owner's manual for information on securing children and vehicle seat belt use.
- Review and follow the information below when selecting the seating location to be used.



### Seating Locations:

National Highway Traffic Safety Administration (NHTSA) alerts vehicle owners that according to accident statistics, children 12 and under are safer when properly restrained in the rear seating positions rather than the front seating positions. For vehicles with air bags, refer to vehicle owner's manual for child restraint installation information.

### Seating Locations That Can Not be Used

1. Seating locations with lap belt only.

Lab Belt Only

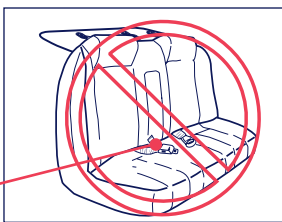

2. Low vehicle seat back.

- Do not use seating locations in which the top of vehicle seat back is below top of child's ears.

Top of vehicle seat below top of ears



3. Seats facing side or rear.

- **DO NOT** use seating locations that face the rear or sides of the vehicle.

Side Facing Vehicle Seats

Rear Facing Vehicle Seat

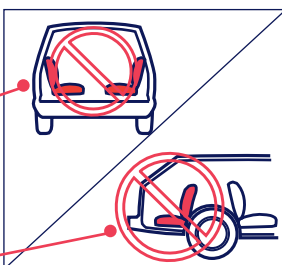

5

### Vehicle Seat Belts:

1. Lap Belts:

- Do **NOT** use seating locations with lap belt only.



Lap Belt Only

2. Passive Restraint Systems:

#### Motorized Shoulder Belts:

- Do not use seating locations with motorized shoulder belts.

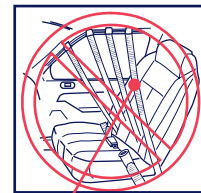

Motorized Shoulder Belt

#### Door Mounted Lap And Shoulder Belt:

- Do not use front seating locations where seat belts are mounted to the front door.

3. LATCH Anchorage System

#### (Lower Anchorage and Tether for Children):

- Do not use the vehicle lower anchorages of the LATCH system with this vest.

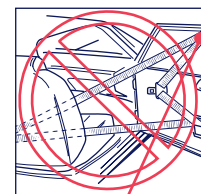

Belts Mounted To Front Door

## ⚠ WARNING ⚠

Avoid serious injury or death: **DO NOT** use vest with vehicle lower anchorages for the Child Restraint Anchorage System or LATCH System.

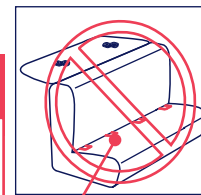

Lower Anchorages

6

## SECURING VEST ON CHILD

- This vest is designed for use with children who weigh between 50 and 80 lbs. (22.7 and 36.3 kg).

### ⚠ WARNING ⚠

- Snugly adjust vest around child.
- Harness belt **MUST** be adjusted so lower panels contact top of thighs and top of vest rests on child's shoulders.
- Discontinue to use vest when:
  - Vest is too small to fit around child's chest.
  - Bottom of front panels do not contact child's thighs when seated.

7

#### Adjust Harness Belt To Adjust Height of Vest To Fit Child:

- With child in seated position, adjust vest so lower panels are lying on top of thighs.
- Adjust harness belt so vest contacts top of child's shoulders.

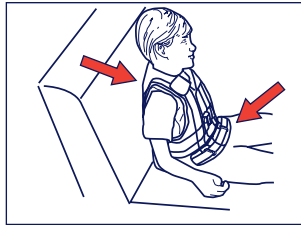

#### To Adjust Harness Belt:

- Disengage fabric fastener on back of vest ①, adjust length of harness belts as required ②, and secure harness belts with fabric fasteners ③.

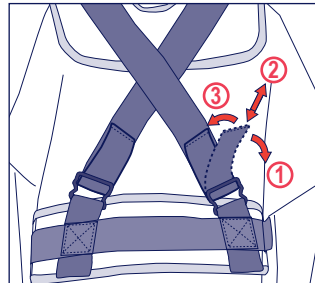

9

#### Placing And Adjusting Vest On Child:

- Open buckle by depressing tongues on sides of buckle and pulling apart.
- Lengthen adjustable belts: Tip and pull out on adjustable tongue.
- Place vest behind child's back and insert child's arms through arm openings of vest.
- Close vest by placing left front panel over right front panel and insert adjustable tongue into buckle. You should hear the buckle click when locked.
- Check that buckle is locked by pulling on the buckle tongue.
- Snugly adjust vest around child by pulling adjustment belt.

Tongue

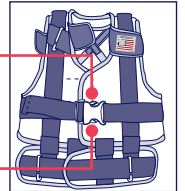

Tongue



8

#### Secure Head Pillow To Vest (Optional):

- Position head pillow at desired position behind child's head and press fabric hook and loop strips together.
- NOTE: Head pillow is an optional accessory. Must be purchased separately. Contact Safe Traffic System for cost and availability.

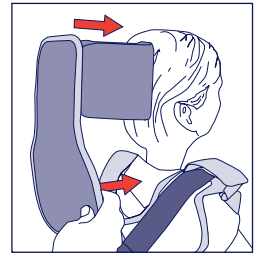

10

## SECURING CHILD WITH VEHICLE LAP AND SHOULDER BELT

### ⚠ WARNING ⚠ DEATH or SERIOUS INJURY can occur

- Use only with the vehicle's lap and shoulder belt. DO NOT use with a lap belt only or lower anchorages of the LATCH system.
- Position and snugly adjust lap belt, then position and adjust shoulder belt.
  - Lap belt must be low on hips, contacting thighs.
  - Shoulder belt must be centered over shoulder (NOT up on neck or low, off shoulder).
  - Do not use shoulder belt loose, positioned under child's arms, or behind child.

- Position child on vehicle seat with child's rump and back against vehicle seat back cushion.
- Route vehicle lap belt through both lap belt guides at lower edge of vest front panels and over child's thighs. Snugly adjust lap belt.
  - Lap belt **MUST** be low on hips and contacting thighs, should not be on abdomen.
- Open shoulder belt positioner cover.
- Snugly adjust shoulder belt and slide shoulder belt under tabs of shoulder belt positioner (see step 1).
  - See vehicle owner's manual for instructions on use and adjustment of the vehicle lap and shoulder belt.

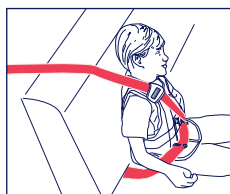

Use with vehicle lap and shoulder belt.

11

- Check position of shoulder belt.
  - Shoulder belt should be in contact with child's chest.
  - Shoulder belt should be centered on child's shoulder, not contacting the neck or face or off shoulder. To relocate the shoulder belt, slide shoulder belt positioner up or down and retighten shoulder belt. Check position of shoulder belt again.

If shoulder belt can not be centered on child's shoulder, move child to another seating position.
- Close shoulder belt positioner cover (see step 2).

#### Shoulder Belt Positioner Cover

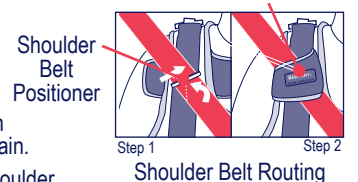

Shoulder Belt Routing

#### To remove child from lap and shoulder belt:

- Open shoulder belt positioner cover and remove shoulder belt from shoulder belt positioner.
- Unbuckle and remove vehicle lap belt from lap belt guides at bottom of front panels of vest.

NOTE: When removing belt, pinch the belt and pull out.

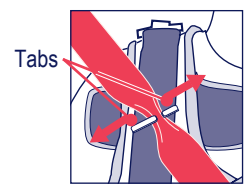

Pinch and Pull Out

12

## RE-USE AFTER A CRASH

### ⚠ WARNING ⚠ DEATH or SERIOUS INJURY can occur

- DO NOT allow any use of this child restraint after a crash unless crash and child restraint meet ALL conditions in this "Re-use After A Crash" section. Do not sell or allow others to use a child restraint that has been in a crash and does not comply with ALL of these conditions.
- This child restraint must be destroyed and replaced if it does not comply with ALL conditions defined by the NHTSA and Safe Traffic System.

Child restraints are often damaged in vehicle crashes and in many cases, the Child restraint must be destroyed and replaced. However, the National Highway Traffic Safety Administration (NHTSA) and Safe Traffic System advise that if a child restraint has been used in a minor crash that the child restraint can continue to be used with your child if the crash and vest meet all of the conditions listed on both the NHTSA and Safe Traffic System websites.

13

The materials used to construct the RideSafer® Travel Vest are designed to deform and absorb energy during a crash. The vest must be fully inspected after a minor crash to identify which components need to be replaced. This information can be found on the Safe Traffic System website.

For NHTSA information on car seat re-use after a crash, check the NHTSA website at: [www.nhtsa.gov/people/injury/childps/ChildRestraints/ReUse/RestraintReUse.htm](http://www.nhtsa.gov/people/injury/childps/ChildRestraints/ReUse/RestraintReUse.htm).

For additional information from Safe Traffic System on re-use of the RideSafer® after a crash and for replacement parts, check the Safe Traffic System website at: [www.safetrafficsystem.com](http://www.safetrafficsystem.com) or [www.ridesafer.net](http://www.ridesafer.net)

Damage to child restraints may be difficult to see or it may be difficult to verify the damage to the child restraint. For those situations where any of the NHTSA Child Restraint Re-Use criteria has not been met, or if there is uncertainty whether damage to the child restraint has occurred, NHTSA and Safe Traffic System advise parents or caregivers to contact their automobile insurance company regarding its policy on replacement of child restraints.

Using any child restraint when uncertain whether it is damaged puts your child at risk for injury or death.

14

## ADDITIONAL INFORMATION

#### Certification:

- Motor Vehicle - Travel Vest has been tested to all applicable requirements of Federal Motor Vehicle Safety Standards. Approved for use in motor vehicles.
- Aircraft - **This Restraint is Not Approved for Use in Aircraft.** Aircraft seats do not provide a lap and shoulder belt system.

#### Care And Cleaning:

- Vest: Surface wash with mild solution of soap and water. Air Dry. Do not machine wash.
- Buckle: Rinse buckle with warm water. DO NOT use household detergents. Never lubricate buckle.

- Discontinue use after 10 years from the "Manufactured In" date printed on inside of vest.

#### Warm Weather:

- Vest parts can get very hot in the sun or warm weather. To avoid burns, always check before putting child in vest.

#### Instruction Manual Storage:

- Store instruction manual in pocket located on right front panel of vest.

Instruction Manual Storage Pocket

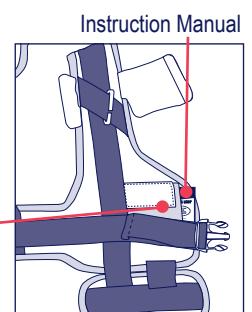

15

16