

# ridesafer<sup>®</sup> DELIGHT

## TRAVEL VEST GEN 5

Use for Beyond DOM of 2022/07

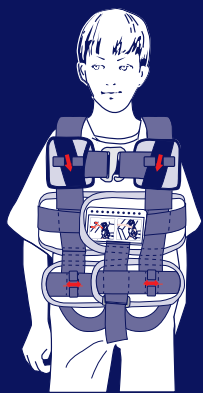

Model Numbers:  
JD14001XXX



### SIZE - EXTRA SMALL

For Children 22 to 40 lbs.  
30-45 inches (76-114 cm)

(10 to 18 kg for international)  
and at least 2 years of age.

- Keep this manual for future use.
- Store in pocket located on right front panel of vest.
- Para instrucciones en Español, llamar al: 1-847-233-0365  
www.safetrafficsystem.com

### Registration Information:

Child restraints could be recalled for safety reasons. You must register this restraint to be reached in a recall. Please register your child restraint by filling out and sending the postage-paid registration card that came with your child restraint.

Safe Traffic System, Inc.  
10201 Pacific Ave., Franklin Park, IL 60131 USA  
or call +1. 847. 233. 0365 or fax +1. 847. 233. 0384  
or register online at <http://ridesafer.net/product-registration/>

### For recall information:

- Call the U.S Government's Vehicle Safety Hotline at 1-888-327-4236 (TTY: 1-800-424-9153)
- Go to [www.NHTSA.gov](http://www.NHTSA.gov)
- Call Safe Traffic System, Inc. at +1. 847. 233. 0365
- Log onto [www.safetrafficsystem.com](http://www.safetrafficsystem.com)

### Manufactured and Distributed By:

Safe Traffic System, Inc.  
10201 Pacific Ave., Franklin Park, IL 60131 USA

© Safe Traffic System, Inc.  
U.S. Pat. 6,902,193 B2 & US 10,661,749B2  
Made in Vietnam

XS10-151-01-01D

### ⚠ WARNING: DEATH or SERIOUS INJURY can occur

- Failure to follow these instructions and vest labels can result in child striking the vehicle's interior during a sudden stop or crash.
- Use only with children who weigh between 22 to 40lbs (10 to 18kg for international) and at least 2 years of age.
- Snugly adjust vest and vehicle seat belts around child. See seat belt adjustment instructions in vehicle owner's manual.
- Always position and snugly adjust lap belt, then adjust top tether or shoulder belt - Lap belt must be low on hips, contacting thighs, not on abdomen.
- **LAP BELT ONLY USE:**
  - Secure with top tether strap and lap belt only.
  - Always secure and snugly adjust the top tether strap provided with this child restraint as specified in this instruction manual.
- **LAP and SHOULDER BELT USE:**
  - Shoulder belt must always be positioned on child's shoulder. NOT under arm or behind back.
- NEVER use with ONLY a lap belt without top tether or shoulder belt.
- For best protection for your child between 2 and 4 years old, use this vest together with the Travel Smarter™ Booster Seat
- Follow all instructions in this manual and the labels on the child restraint.
- Register your child restraint with the manufacturer via online or postcard.
- DO NOT use the vest, top tether or crotch strap after a crash unless all conditions for reuse are met in "Re-use After a Crash" section.

### SAFETY CHECK LIST

- ✓ Read and understand the instruction manual and vest labels.
- ✓ Child is at least 2 years of age and weighs at least 22 pounds (10 kg).
- ✓ Position and snugly adjust lap belt, then adjust top tether or shoulder belt.
- ✓ Lap belt must be flat on thighs or low on hips, not across the abdomen.
- ✓ **LAP BELT USE:** Always use top tether when using the vest with a lap belt only.
- ✓ **LAP and SHOULDER BELT USE:** Never put shoulder belt under child's arm or behind child.
- ✓ Secure child in back seat whenever possible.
- ✓ Top of child's ears must be below top of vehicle seat back.
- ✓ Never leave child unattended.
- ✓ Discontinue use when child's weight exceeds 40 pounds (18 kg).
- ✓ Do not allow anyone (babysitter, relatives, etc.) to use travel vest without first understanding all instructions.
- ✓ Secure or store vest when not in use. An unsecured child restraint system can injure other occupants in a crash.
- ✓ Discontinue use after 5 years from the date of purchase.

2

### HEIGHT & WEIGHT INFORMATION

- Requirements for use:
  - Weight between 22 to 40lbs (10 to 18 kg)
  - Height between 30 to 45 inches (76 to 114 cm)
  - At least 2 years of age
- Fit of vest on child:
  - Vest MUST adjust to fit snugly around child's chest
  - Bottom front flap of vest must be flat on the thighs of the child.
- For best positioning:
  - If your child is between 2 and 4 years old, use this vest together with the Travel Smarter™ Booster Seat
  - **Use of top tether is required with lap belt only and recommended with lap and shoulder belt.**
- Discontinue use when:
  - Vest is too small to fit around child's chest
  - Bottom of front panels do not contact top of child's thighs when seated
  - Child's weight exceeds 40 pounds (18 kg)

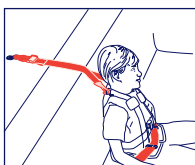

Use with top tether and lap belt only.

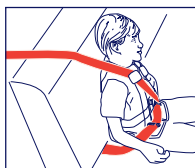

Use with lap and shoulder belt.

### RIDESAFAER BELT POSITIONING TRAVEL VEST & PARTS

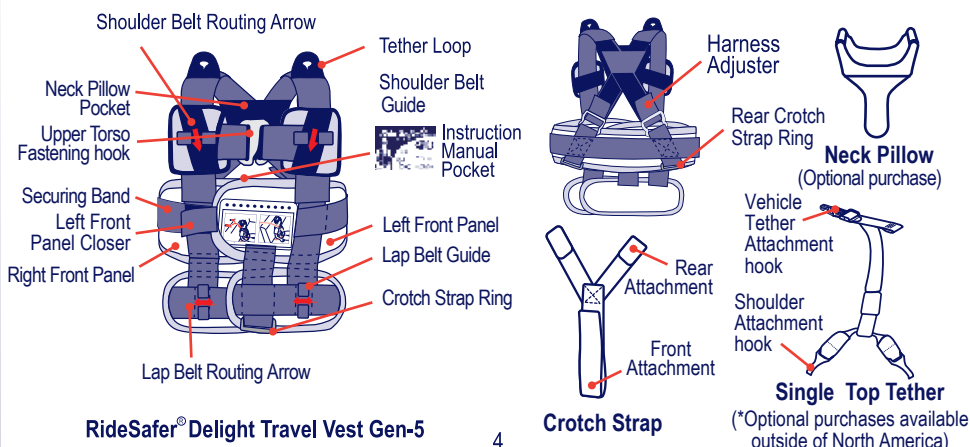

RideSafer® Delight Travel Vest Gen-5

4

### SELECTING A VEHICLE SEATING LOCATION

The RideSafer® Travel Vest is designed for use with either a vehicle lap belt and top tether or vehicle lap and shoulder belt.

How you use the vest depends on the vehicle seat location used, the vehicle seat belt system and availability of a top tether anchorage in the vehicle.

- Refer to vehicle owner's manual for the type of vehicle seat belts and availability of top tether anchors. If the vehicle does not have a top tether anchor in a seating location, a tether anchor may be added. Refer to vehicle owner's manual or contact vehicle dealer.
- Refer to vehicle owner's manual for information on securing children and vehicle seat belt use.

Review and follow the information below before using.

### Seating Locations:

National Highway Traffic Safety Administration (NHTSA) alerts vehicle owners that according to accident statistics, children 12 and under are safer when properly restrained in the rear seating positions rather than the front seating positions. For vehicles with air bags, refer to vehicle owner's manual for child restraint installation information.

### Seating Locations That Can Not be Used

#### 1. Low vehicle seat back.

- Do not use seating locations in which the top of vehicle seat back is below top of child's ears.

Top of vehicle seat below top of ears



#### 2. Seats facing side or rear.

- DO NOT use seating locations that face the rear or sides of the vehicle.



Side Facing Vehicle Seats

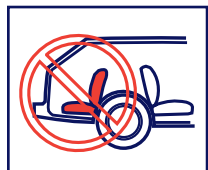

Rear Facing Vehicle Seat

### Vehicle Seat Belts:

#### 1. Lap Belts:

##### Vehicle Seating Locations With Only A Lap Belt:

- A seating location equipped with only a vehicle lap belt must also have a top tether anchor.
- DO NOT use seating locations with lap belt only that do not have top tether anchors until a top tether anchor has been installed.

Top Tether Anchor

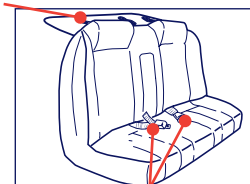

Lap Belt Only

#### 2. Passive Restraint Systems:

##### Motorized Shoulder Belts:

- DO NOT use seating locations with motorized shoulder belts.

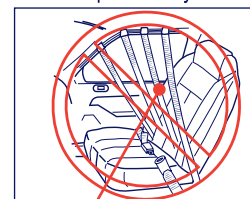

Motorized Shoulder Belt

##### Door Mounted Lap And Shoulder Belt:

- DO NOT use front seating locations where seat belts are mounted to the front door.

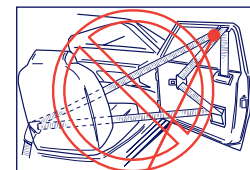

Belts Mounted To Front Door

#### 3. LATCH Anchorage System (Lower Anchorage and Tether for Children):

- DO NOT use the vehicle lower anchorages of the LATCH system with this vest.

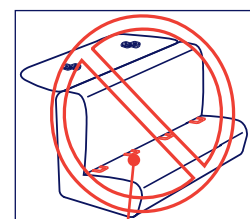

Lower Anchorages

### ⚠ WARNING ⚠

Avoid serious injury or death: DO NOT use vest with vehicle lower anchorages for the Child Restraint Anchorage System or LATCH System.

6

5



## SECURING VEST ON CHILD

- This vest is designed for use with children who weigh between 22 to 40 lbs (10 to 18kg for International) and at least 2 years of age.

Fastening Hook  
Fastening Loop

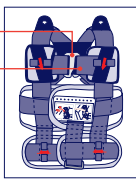

### To Open Vest:



7

### ⚠ WARNING ⚠

- Snugly adjust vest around child.
- Discontinue to use vest when:
  - Vest is too small to fit around child's chest.
  - Bottom of front panels do not lie flat and contact child's thighs when seated.

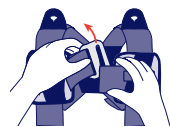

Lift the fastening hook through the loop to remove.

### Place Vest On Child:

- Pull the fastening hook out of the loop and open vest.
- Place vest behind child's back and insert child's arms through arm openings of vest.
- Close vest by placing left front panel over right front panel.
- Insert the fastening hook into the loop. (Figure A)
- Attach the crotch strap to the front crotch strap ring, route the belt between the child's legs. Attach the 2 rear loops to the rear crotch strap rings by opening the Velcro, feeding the webbing through the rings and securing the Velcro closed.

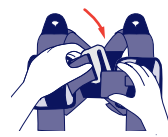

(Figure A)

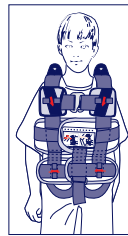

### Place Neck Pillow On Vest: (optional)

Locate neck pillow pocket at back of vest. Place neck pillow into pocket. Position neck pillow to support child's neck by adjusting inserting depth.

### To Adjust Harness Height:

Disengage fabric fastener on back of vest ①, adjust length of harness belts as needed ②, and secure harness belts with fabric fasteners ③.

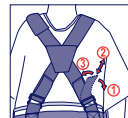

8

## SECURING CHILD IN VEHICLE

### ⚠ WARNING ⚠ DEATH or SERIOUS INJURY can occur

- To avoid injury, this restraint, vehicle belts, and top tether should be secured and adjusted by an adult. NEVER allow child to buckle or adjust belts.
- Snugly adjust the vehicle seat belt around child according to the instructions in the vehicle owner's manual.
  - Vehicle lap belt must be low on hips and contacting the thighs. An improperly positioned vehicle lap belt can cause serious abdominal injury or death.
  - Do not allow child to slide down in vehicle seat which could position vehicle lap belt across child's abdomen or shoulder belt over neck or face.
  - Vehicle belts MUST be flat against child and MUST NOT be twisted.

### Securing Child With Vehicle Top Tether and Lap Belt

### ⚠ WARNING ⚠ DEATH or SERIOUS INJURY can occur

- Always use top tether strap when using a lap belt only.
- Never use vest with only a lap belt.
- Position and snugly adjust lap belt, then attach and snugly adjust top tether.
- DO NOT over tighten top tether. Over tightening the top tether can raise the vehicle lap belt up on child's abdomen exposing the child to the risk of abdominal injury in a crash.
- Only use the top tether provided with this travel vest. Do NOT use top tether with other products.

- Locate end of tether with single tether hook and belt adjuster. Attach single tether hook to the vehicle top tether anchorage behind the seating location where child will be seated.
- Position child on vehicle seat with child's bottom and back against vehicle seat back cushion.
- Route lap belt through both lap belt guides at lower edge of vest front panels and over child's thighs. Snugly adjust lap belt. Lap belt MUST contact thighs, and should not be positioned up on abdomen.
- Attach the two tether hooks on the free end of the top tether strap, to the tether loops located at the top of the shoulders.
- Snugly adjust top tether to remove all slack.
- Check that vehicle lap belt is low on child's hips, touching the top of the thighs. If vehicle lap belt is not low on the hips, touching the top of the thighs, loosen top tether, retighten vehicle lap belt, and then snugly adjust tether again.



Lap Belt and Tether

### To remove child from top tether and lap belt:

- Loosen top tether and unhook tether hooks from both shoulders.
- Unbuckle and remove vehicle lap belt from lap belt guides at bottom of front panels of vest.

9

### Securing Child With Vehicle Lap and Shoulder Belt

### ⚠ WARNING ⚠ DEATH or SERIOUS INJURY can occur

- Use in this mode only with the vehicle's lap and shoulder belt. DO NOT use with a lap belt only or lower anchorages of the LATCH system.
- Position and snugly adjust lap belt, then position and adjust shoulder belt.
  - Lap belt must be low on hips, flat and contacting thighs.
  - Shoulder belt must be centered over shoulder (NOT up on neck or low, off shoulder).
  - Do not use shoulder belt loose, positioned under child's arms, or behind child.

- Position child on vehicle seat with child's rump and back against vehicle seat back cushion.
- Route vehicle lap belt through both lap belt guides at lower edge of vest front panels and over child's thighs. Snugly adjust lap belt.
  - Lap belt MUST be low on hips and contacting thighs, should not be on abdomen.
- Snugly adjust shoulder belt and slide shoulder belt under tabs of shoulder belt positioner (see step 1).
  - See vehicle owner's manual for instructions on use and adjustment of the vehicle lap and shoulder belt.
- Check position of shoulder belt.
  - Shoulder belt should be in contact with child's chest.
  - Shoulder belt should be centered on child's shoulder, not contacting the neck or face or off shoulder. To relocate the shoulder belt, slide shoulder belt positioner up or down and retighten shoulder belt. Check position of shoulder belt again. If shoulder belt cannot be centered on child's shoulder, move child to another seating position.

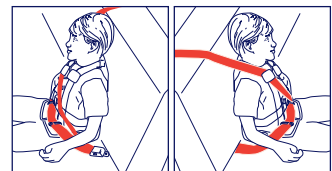

Lap and Shoulder Belt



Shoulder Belt Routing

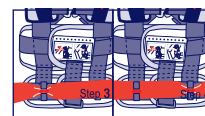

Lap Belt Routing



Pinch and Pull Out

\*Use of the top tether is highly recommended with lap and shoulder belt use.

### To remove child from lap and shoulder belt:

- Open shoulder belt positioner cover and remove shoulder belt from shoulder belt positioner.
- Unlock and remove vehicle lap belt from lap belt guides at bottom of front panels of vests.

Note: When removing belt, pinch the belt and pull out.

10

## RE-USE AFTER A CRASH

### ⚠ WARNING ⚠ DEATH or SERIOUS INJURY can occur

- DO NOT allow any use of this child restraint after a crash unless crash and child restraint meet ALL conditions in this "Re-use After A Crash" section. Do not sell or allow others to use a child restraint that has been in a crash and does not comply with ALL of these conditions.
- This child restraint must be destroyed and replaced if it does not comply with ALL conditions defined by the NHTSA and Safe Traffic System, Inc.

Child restraints are often damaged in vehicle crashes and in many cases, the child restraint must be destroyed and replaced. However, the National Highway Traffic Safety Administration (NHTSA) and Safe Traffic System advise that if a child restraint has been used in a minor crash that the child restraint can continue to be used with your child if the crash, vest and top tether meet all of the conditions listed on both the NHTSA and Safe Traffic System websites.

The materials used to construct the RideSafer Travel Vest and top tether are designed to deform and absorb energy during a crash. The vest must be fully inspected after a minor crash to identify which components need to be replaced. This information can be found on the Safe Traffic System website.

For NHTSA information on car seat re-use after a crash, check the NHTSA website at: <https://www.nhtsa.gov/car-seats-and-booster-seats/car-seat-use-after-crash>

For additional information from Safe Traffic System on re-use of the RideSafer® after a crash and for replacement parts, check the Safe Traffic System website at: [www.safetrafficsystem.com](http://www.safetrafficsystem.com)

Damage to child restraints may be difficult to see or it may be difficult to verify the damage to the child restraint. For those situations where any of the NHTSA Child Restraint Re-Use criteria has not been met, or if there is uncertainty whether damage to the child restraint has occurred, NHTSA and Safe Traffic System advise parents or caregivers to contact their automobile insurance company regarding its policy on replacement of child restraints. Using any child restraint when uncertain whether it is damaged puts your child at risk for injury or death.

11

## ADDITIONAL INFORMATION

### Top Tether And Anchorage Information:

- Use of top tether is required when using a vehicle lap belt only.
- Proper tether anchor hardware is required in the vehicle. Check vehicle owner's manual, call your vehicle dealer or call Safe Traffic System, Inc. for information on tether anchorages and hardware.
- If your vehicle dealer is unable to assist you or you have additional questions, call the vehicle manufacturer or Safe Traffic System, Inc.

### Certification:

- Motor Vehicle** - This child restraint system conforms to all applicable Federal Motor Vehicle Safety Standards.
- Aircraft** - This Restraint Is Not Certified For Use in Aircraft without the FlySafer® Aircraft Attachment Strap manufactured by Safe Traffic System, Inc.

### Using with TravelSmarter™ Booster Seat.

RideSafer® Travel Vest can be used with TravelSmarter™ Booster Seat to increase convenience. In order to use TravelSmarter™ Booster Seat with RideSafer® Travel Vest, please follow the direction and warning included within TravelSmarter™ Booster Seat. The weight range requirement defaults to the weight requirement on the RideSafer® Travel Vest.

### ⚠ WARNING ⚠ DEATH or SERIOUS INJURY can occur

Always follow direction of TravelSmarter™ Booster Seat and RideSafer® Travel Vest to avoid any injury by impact in case of accident or sudden stop.

### Emergency Escape (One Touch Escape System use mode)

- Step by Step for Lap Shoulder Belt use Mode** Step 1- Unlock the vehicle seat belt buckle and quickly remove vehicle lap and shoulder belt from belt guides of the vest by pulling forcefully up through the guides. Step 2- Exit from the vehicle wearing the vest
- Escape Step by Step for Lap & Tether use Mode** Step 1- Loosen top tether and remove tether hook from both shoulders. Step 2- Hold unbuckled vehicle lap belt and quickly remove the belt from the guides at bottom of front panels of the vest by pulling forcefully upward. Step 3- Exit out from the vehicle wearing the vest
  - Discontinue use after 10 years from the date of manufacture printed on inside of vest.

### Warm Weather:

- Some of the metal vest parts can get very hot in the sun or warm weather. To avoid burns, always check before putting child in vest.

### Instruction Manual Storage:

- Store instruction manual in pocket located on front of right front panel of vest.

### Care And Cleaning:

- Vest:** Surface wash with mild solution of soap and water. Air Dry. Machine wash in laundry bag, on gentle cycle with mild detergent then air dry.
- Locking Device:** Rinse with warm water. DO NOT use household detergents.
- Top Tether:** Surface wash with mild solution of soap and water. Air Dry. Go to [ridesafer.net/FAQ](http://ridesafer.net/FAQ) for detail.
- Crotch Belt:** Surface wash with mild solution of soap and water. Air Dry. Do not machine wash.

12